

FED. ROAD DIST. NO.	STATE	FED. AID PROJECT NO.	FISCAL YEAR	SHEET NO.	TOTAL SHEETS
6	ARK.	S-876 (1) S-877 (1) & S-878 (1)		1	10
STATE JOB NO. C-6392					24

STATE OF ARKANSAS  
STATE HIGHWAY COMMISSION

INDEX OF SHEETS

Job No.	SHEET No.	Drwg. No.	TITLE
C-6392	1	7706	Title Sheet For Job No. C-6392
	2	7707	Schedule of Br. Quantities
	3	7708	Layout of Br. No. 4053, 4054 & 4055
	4	7709	" " " 4056 & 4057
	5	7710	" " " 4058, 4059 & 4060
	6	7711	" " " 4061, 4062 & 4063
	7	7712	" " " 4064 & 4065
	8	7713	" " " 4066 & 4067
	9	7714	" " " 4068 & 4069
	10	7715	" " " 4070, 4071 & 4072
	11	7716	" " " 4073, 4074, 4075 & 4076
	12	7717	" " " 4077, 4078 & 4079
	13	7718	Details of Single Span Br. No. 4053-4055, 4057-4063, 4065 & 4065-4074
	14	7719	Details of Br. No. 4056
	15	7720	" " " 4064, 4067, & 4068
	16	7721	" " " 4066, 4067, & 4068
	17	7722	" R.C. Headwall Brs. No. 4075, 4076, 4077 & 4078
	18	7723	Details of Br. No. 4079
	19	F.P.C. 12	Standard Pipe Culverts and Headwalls
	20	G.R. 6	Standard Details of Steel Plate Guard Fence
	21	1888	Bankment Construction at Bridge Ends and Fill for Structure.
	22	1891	Basis for Computing Excavation for Structures.
	23	1896	Standard Barricade, Warning and Signs
	24	FPM-2	Reinforced Conc. Markers (RW & Proj. Marker)

PLAN OF PROPOSED BRIDGES  
NORTH PULASKI COUNTY BRIDGES  
PULASKI COUNTY

ROUTE F.A.S. 1488, 1489 & 1152

JOB NO C-6392

FEDERAL AID PROJECT NOS. S-876(1), S-877(1) & S-878(1)

SPECIFICATIONS: ARKANSAS STATE HIGHWAY COMMISSION  
STANDARD SPECIFICATIONS FOR ROAD AND BRIDGE CONSTRUCTION  
ADOPTED MARCH 1, 1940 WITH THE SPECIAL PROVISIONS LISTED BELOW

PAMPHLETS	
DIVISION	PART
I	1, 4, 8A, 8B, 9
II	
III	
IV	

No.	SPECIAL PROVISIONS TITLE	NO SHEETS
	Required Contract Provisions	7 7 7
	State and County Agreements	1 1 1
2-1	Revision of Article 2-11	2 2 2
2-2	Equipment List Required	1 1 1
2-4	State License For Contractors	1 1 1
4-1	Revision of Article 4.9	1 1 1
5-4	Fed. Aid Secondary Project off State Highway System	1 1 1
8-3	Special Provision pertaining to the required Contract Provisions for Federal Aid Projects	1 1 1
9-5	Partial Payments	2 2 2
107-4	Revision of Section 107.2	1 1 1
SP 805-3	Steel Plate Guard Rail	1 1 1
853-1	Machine Mixing	1 1 1
	At Run Groves on County Projects	1 1 1
	Job C-6392 Remodeling of Existing Bridge Structures	1 1 1
	Job C-6392 Embankment Construction At Bridge Ends	2 2 2
	929-1 Project Marker Posts	1 1 1
	F.A.P. No. S-878 (1)	

F.A.P. No. S-876(1)

BRIDGE No. 4053 Log 44.8  
Sta 6+84.9 to 6+72.9  
Job No. C-6392  
F.A.P. No. S-876(1)

BRIDGE No. 4054 Log 44.95  
Sta 6+79.7 to 6+75.3  
Job No. C-6392  
F.A.P. No. S-876(1)

BRIDGE No. 4055 Log 45.5  
Sta 6+29.7 to 6+37.7  
Job No. C-6392  
F.A.P. No. S-876(1)

BRIDGE No. 4056 Log 47.5  
Sta 6+49.2 to 6+30.85  
Job No. C-6392  
F.A.P. No. S-876(1)

BRIDGE No. 4057 Log 48.3  
Sta 6+40.18 to 6+35.60  
Job No. C-6392  
F.A.P. No. S-876(1)

F.A.P. No. S-877(1)

BRIDGE No. 4058 Log 38.3  
Sta 6+43.82 to 6+57.4  
Job No. C-6392  
F.A.P. No. S-877(1)

BRIDGE No. 4059 Log 39.6  
Sta 6+50.0 to 6+57.9  
Job No. C-6392  
F.A.P. No. S-877(1)

BRIDGE No. 4060 Log 39.6  
Sta 6+36.1 to 6+52.1  
Job No. C-6392  
F.A.P. No. S-877(1)

BRIDGE No. 4061 Log 41.4  
Sta 6+32.32 to 6+47.99  
Job No. C-6392  
F.A.P. No. S-877(1)

BRIDGE No. 4062 Log 42.7  
Sta 6+39.70 to 6+55.45  
Job No. C-6392  
F.A.P. No. S-877(1)

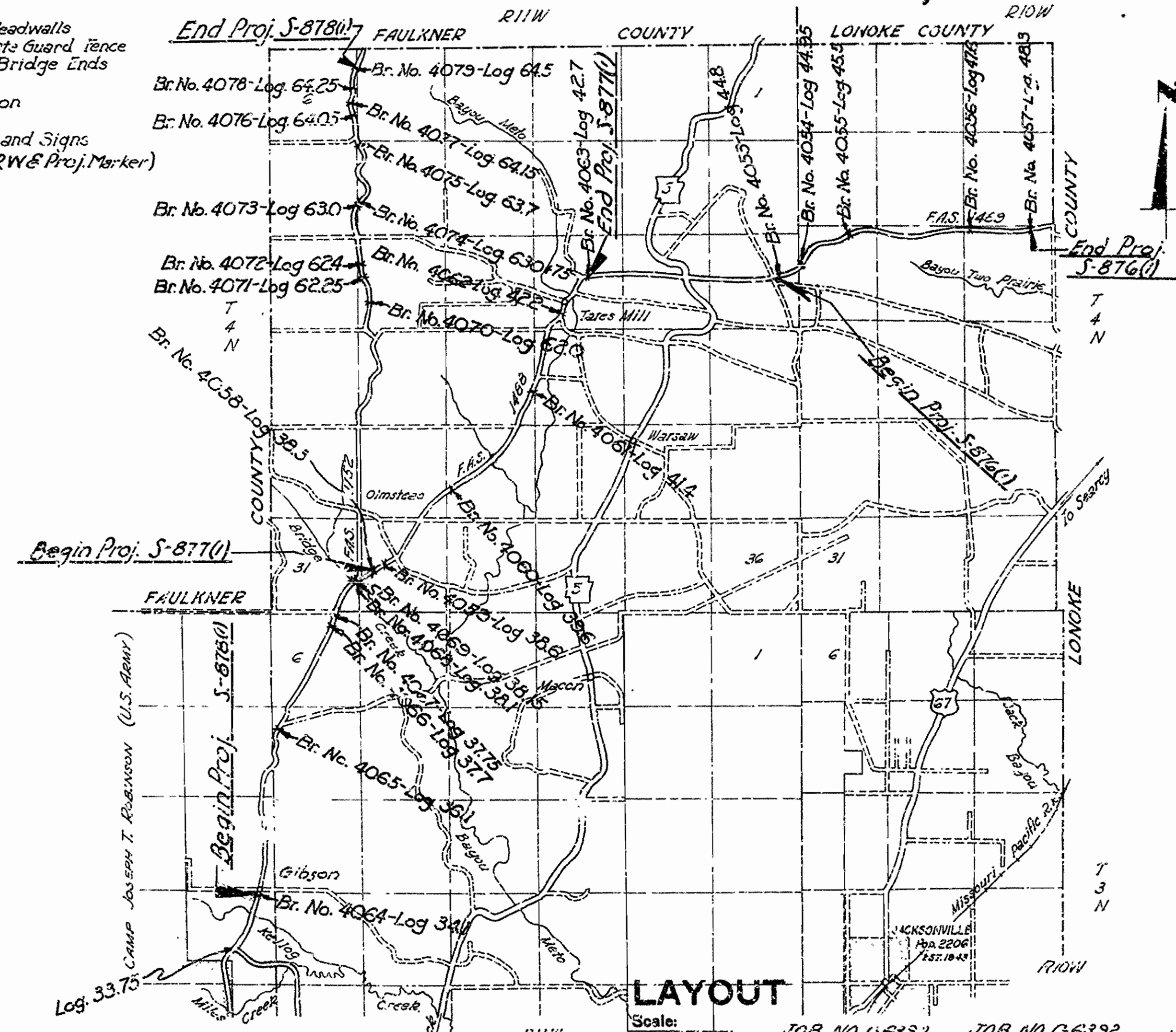

BRIDGE No. 4064 Log 34.1  
Sta 6+25.2 to 6+53.03  
Job No. C-6392  
F.A.P. No. S-878(1)

BRIDGE No. 4065 Log 36.1  
Sta 6+10.33 to 6+20.33  
Job No. C-6392  
F.A.P. No. S-878(1)

BRIDGE No. 4066 Log 37.7  
Sta 7+26.25 to 6+65.84  
Job No. C-6392  
F.A.P. No. S-878(1)

BRIDGE No. 4067 Log 37.75  
Sta 10+31.20 to 10+58.95  
Job No. C-6392  
F.A.P. No. S-878(1)

BRIDGE No. 4068 Log 38.1  
Sta 6+93.80 to 6+84.47  
Job No. C-6392  
F.A.P. No. S-878(1)

BRIDGE No. 4069 Log 38.15  
Sta 9+23.50 to 9+39.43  
Job No. C-6392  
F.A.P. No. S-878(1)

BRIDGE No. 4070 Log 38.0  
Sta 6+62.20 to 6+78.20  
Job No. C-6392  
F.A.P. No. S-878(1)

BRIDGE No. 4071 Log 38.25  
Sta 6+50.4 to 6+58.4  
Job No. C-6392  
F.A.P. No. S-878(1)

BRIDGE No. 4072 Log 62.4  
Sta 6+67.3 to 6+89.09  
Job No. C-6392  
F.A.P. No. S-878(1)

BRIDGE No. 4073 Log 63.0  
Sta 6+78.8 to 6+84.8  
Job No. C-6392  
F.A.P. No. S-878(1)

BRIDGE No. 4074 Log 63.075  
Sta 7+40.42 to 7+54.42  
Job No. C-6392  
F.A.P. No. S-878(1)

BRIDGE No. 4075 Log 62.7  
Sta 6+49.0 to 6+56.75  
Job No. C-6392  
F.A.P. No. S-878(1)

BRIDGE No. 4076 Log 64.05  
Sta 6+38.0 to 6+46.0  
Job No. C-6392  
F.A.P. No. S-878(1)

BRIDGE No. 4077 Log 64.15  
Sta 6+55.4 to 6+67.4  
Job No. C-6392  
F.A.P. No. S-878(1)

BRIDGE No. 4078 Log 64.25  
Sta 11+07.5 to 11+82.5  
Job No. C-6392  
F.A.P. No. S-878(1)

BRIDGE No. 4079 Log 64.5  
Sta 6+96.72 to 7+44.80  
Job No. C-6392  
F.A.P. No. S-878(1)

LENGTH OF PROJECT	LENGTH OF BRIDGES	LENGTH OF EMBANKMENT	LENGTH OF JOB	GROSS LENGTH OF PROJECT	NET LENGTH OF PROJECT	NET LENGTH OF BRIDGES	NET LENGTH OF ROADWAY
278.45'	31.63'	247.02'	278.45'	278.45' OR 0.05 MI.	278.45' " 0.751 "	31.63' " 0.005 "	247.02' " 0.046 "
93.05'	93.05'	93.05'	93.05'	93.05' OR 0.017 MI.	93.05' " 0.117 "	0.00' " 0.000 "	93.05' " 0.017 "
929.24'	929.24'	929.24'	929.24'	929.24' OR 0.176 MI.	929.24' " 0.176 "	321.12' " 0.061 "	608.12' " 0.115 "

JOB C-6392  
1300.94' OR 0.244 MI.  
1300.94' " 0.244 "  
352.75' " 0.065 "  
948.19' " 0.179 "

APPROVED  
CHIEF ENGINEER-STATE HIGHWAY COMMISSION

APPROVED  
CHAIRMAN-STATE HIGHWAY COMMISSION

RECOMMENDED FOR APPROVAL  
DISTRICT ENGINEER  
DEPARTMENT OF COMMERCE  
BUREAU OF PUBLIC ROADS

APPROVED  
DIVISION ENGINEER  
DEPARTMENT OF COMMERCE  
BUREAU OF PUBLIC ROADS



SUMMARY OF QUANTITIES

PROJECT NO.	STATE	PROJECT NO.	YEAR	SHEET NO.	TOTAL SHEETS
6	ARK.	875 07	1950	2	10
STATE JOB NO. C-6392		BRIDGE NO.	DATE	BY	
		1152	5-17-50	W.D. DORR	

ROADWAY ITEMS - CODE 2010

BRIDGE ITEMS CODE-X-020

ITEM NO.	ITEM	QUANTITY			JOB C-6392	UNIT	ITEM NO.	ITEM	QUANTITY			JOB C-6392	UNIT
		S-878(1)	S-877(1)	S-876(1)					S-878(1)	S-877(1)	S-876(1)		
SP 102	UNCLASSIFIED EXCAVATION	1650	695	535	2880	CU.YDS.	103	DRY EXCAVATION FOR STRUCT.	24	0	0	30	CU.YDS.
103	DRY EXCAVATION FOR STRUCT.	79	25	19	123	"	S.P. 802	CLASS 5 CONC FOR BRIDGES	302.55	0	31.15	333.70	"
SP 404	GRAVEL SURFACE COURSE	126	0	0	126	"	S.P. 803	REINFORCING STEEL FOR BRGS	48.710	0	5460	54.150	POUNDS
S.P. 802	CLASS 5 CONC FOR BRIDGES	95.3	82.83	42.34	220.47	"	S.P. 805	STEEL PLATE GUARD RAIL	90.9	0	118	1027	LIN. FT.
S.P. 803	REINFORCING STEEL FOR BRGS	176.70	14,070	7020	38,760	POUNDS	S.P.	REMODELING EXIST. BR. STRUCT.	48.25%	0	4.50%	52.75%	COMPLETE
906	24" REINF. CONC. PIPE CULV.	24	0	0	24	LIN. FT.							
906	30" " " "	48	0	0	48	"							
906	42" " " "	24	0	0	24	"							
S.P.	EMBANKMENT MATERIAL	895	0	44	939	CU.YDS.							
S.P.	REMODELING EXIST. BR. STRUCT.	24.75%	13.50%	9.00%	47.25%	COMPLETE							
SP 929-1	PROJECT MARKER POSTS	2	2	2	6	EACH							

JOB NO.	ROUTE No.	F.A.S. No.	LOG	ITEM NO.	ITEM	SP		103	404	SP & 802	SP 803	SP 805	906	SP	SP 929-1				
						UNCLASSIFIED EXCAV.	EMBANKMENT MATL.	DRY EXCAVATION FOR STRUCTURES	GRAVEL SURFACE COURSE	CLASS 5" CONCRETE FOR BRIDGES	REINFORCING STEEL FOR BRIDGES	STEEL PLATE GUARD RAIL	REINFORCED CONCRETE PIPE CULVERT	REMODELING OF EXISTING BRIDGE STRUCTURES	PROJECT MARKER POSTS				
				BRIDGE NO.	UNIT	CU.YD.	CU.YD.	CU. YD.	CU YD	CU YD	LB.	LIN. FT.	LIN. FT.	COMPLETE	EACH				
C-6392	FAS 1152	5 978 (1)	34.1	4064**	*100					24.28	4,340	108		4.5%	1				
			36.1	4065	*115		4			7.67	1,040				2.25				
			37.7	4066**	*100	250	- 8	40			121.22	18,070	315		19.00				
			37.75	4067**	*100	250	4	40			31.39	3,860	108		4.50				
			38.1	4068**	*100		4				71.74	12,030	231		13.50				
			38.15	4069	*100		4				16.48	2,820			2.25				
			62.0	4070	*135		4				14.39	2,460			2.25				
			G225	4071	*100		4				5.78	990			2.25				
			62.4	4072	*100		4				14.02	2,410			2.25				
			63.0	4073			12				10.96	990			2.25				
			63.0+75'	4074			6				12.64	2,050			2.25				
			63.7	4075	*100	20	8				2.92	270		24	2.25				
			64.05	4076	*100	15	17				2.22	240		24	2.25				
			64.15	4077	*100	30	9				4.22	400		24	2.25				
			64.25	4078	*100	30	7				4.01	370		24	2.25				
			64.5	4079**	*100	300	8	46			53.92	10,460	147		6.75	1			
								*1650	895	103	126	397.86	66,380	907	24	48	24	73.00%	2
			FAS 1438	5 877 (1)	38.3	4058	*120		4			11.50	2,040			2.25%	1		
					38.6	4059	*100		5			14.39	2,250			2.25			
					39.6	4060	*100		4			14.42	2,460			2.25			
41.4	4061	*105				4			13.91	2,430			2.25						
42.2	4062	*125				4			14.13	2,450			2.25						
42.7	4063	*145				4			14.48	2,440			2.25						
						*695	0	25	0	82.83	14,070	0	0	0	0	13.50%	2		
FAS 1489	5 876 (1)	44.3	4053	*110		5			6.22	990			2.25%	1					
		44.95	4054	*100		5			16.52	2,760			2.25						
		45.5	4055	*100		5			6.22	990			2.25						
		47.6	4056**	*125	44	6			31.15	5,480	118		4.50						
		48.3	4057	*100		4			13.38	2,260			2.25						
					*535	44	25	0	73.49	12,500	118	0	0	0	13.50%	2			
				SUMMARY		*2880	939	153	126	554.18	92,950	1027	24	48	24	100%	6		

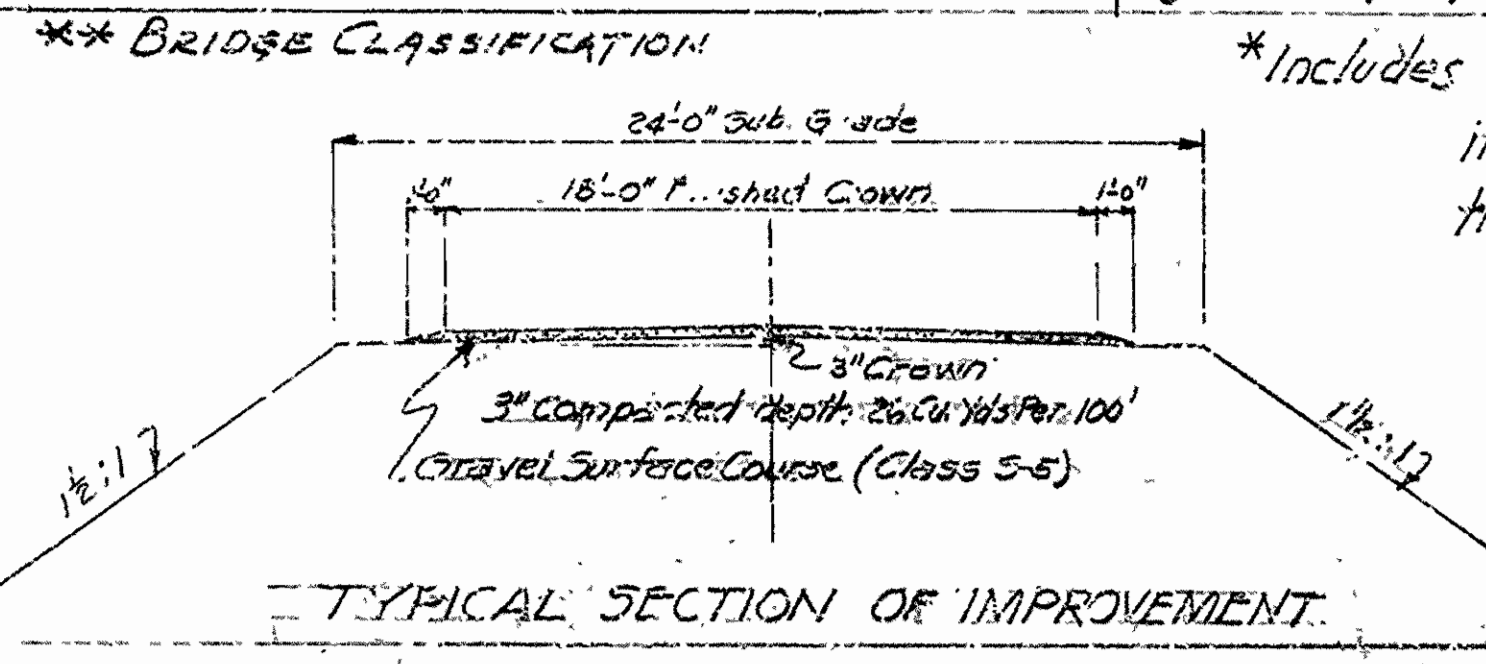

\*\* BRIDGE CLASSIFICATION  
 \*Includes 100 cu. yds per Bridge which may be required in channel improvement if directed by the engineer.

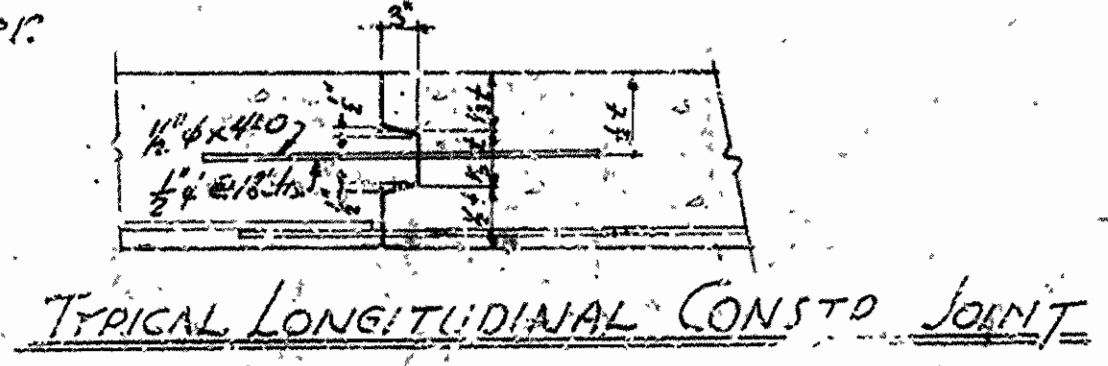

SUMMARY OF QUANTITIES & TYPICAL SECTION  
 NORTH PULASKI COUNTY BRIDGES  
 PULASKI COUNTY  
 FAS ROUTES 1152, 1438 & 1489.  
 ARKANSAS STATE HIGHWAY COMMISSION  
 LITTLE ROCK, ARK.  
 Drawn By L.A.M. Date 5-17-50 No Scale  
 Checked by Bridge Design Engineer Date  
 Bridge Nos. DRWG. NO. 7707



NO.	DATE	BY	TOTAL SHEETS
6	5-23-11		4-19
STATE JOB NO. C-6372			6-24

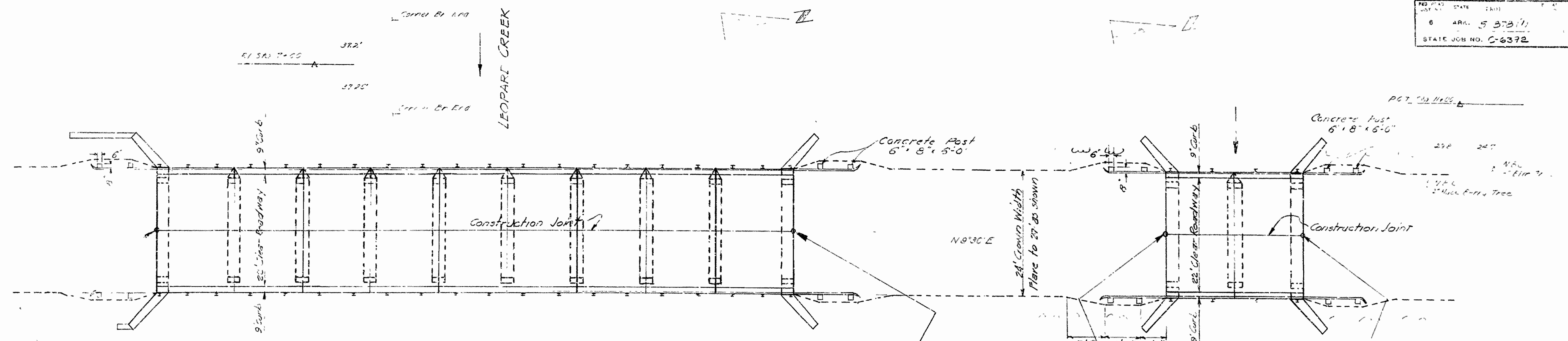

PLAN

PLAN

For Details of Bridge No 4066 See Drawing No 7721

NOTE: bridge contractor to remove existing under spans substructure to be retained

Construction joint is to be made on  $\frac{1}{4}$  bridge. Pour one half of R.C. Slab roadway, and maintain traffic on remaining half of existing bridge deck.

NOTE: bridge contractor to remove existing under spans substructure to be retained

For Details of Bridge No 4066 See Drawing No 7721

NOTE: All posts shown in fill are 6' x 8' x 6'-0" concrete post. See Brwg 7721 No 7721 for special details.

Loading H-15  
Stresses Class "B" Conc. 1300#15" #10  
Reinf Steel 20,000#10"

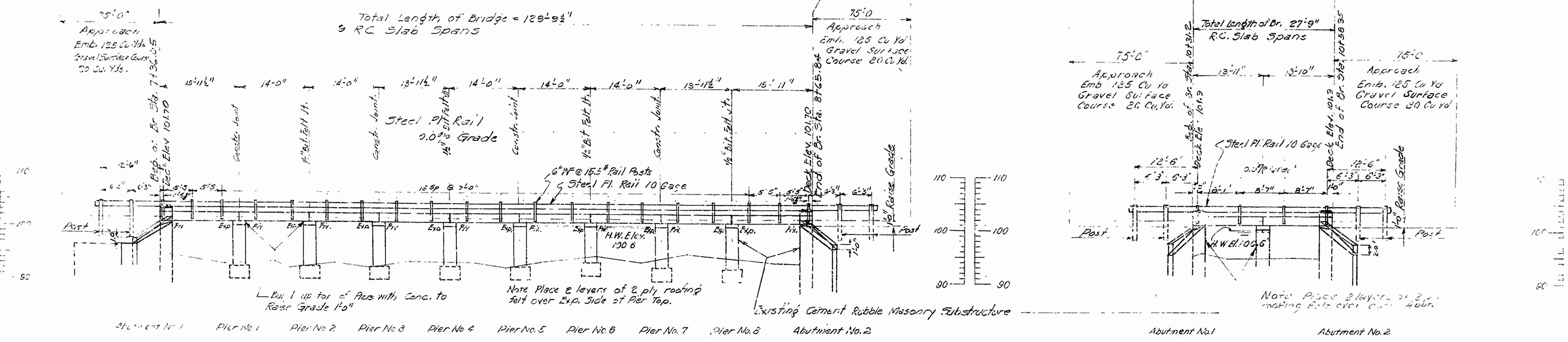

ELEVATION

ELEVATION

BR. NO. 4066-ROUTE 1152- LOG 37.7

BR. NO. 4067-ROUTE 1152 LOG 37.75

Design Live Load: H-15  
Unit Stresses: - Concrete 1300#15" #10  
Reinforcing Steel 20,000#10"

Drainage Area = 9.56 mi.  
Br. No. 4067 is Relief for Br. No. 4066  
Area Reg. = 661 sq. ft.  
Area Provided 680 sq. ft.

B.M. Elev. 100.0  
Nail in Root of 24" J Gum Tree  
50' Lt. Sta. 8+29

LAYOUT OF BRIDGES  
ON F.A.S. ROUTE 1152  
PULASKI CTY.  
LOG 37.7 & 37.75  
ROUTE SEC.

ARKANSAS STATE HIGHWAY COMMISSION  
LITTLE ROCK, ARK.  
Scale: 1/4" = 10'-0"  
Drawn By: [Signature] Date: 4-28-50  
Traced By: [Signature] Date: 5-22-50  
Checked By: [Signature] Date: 5-22-50  
BRIDGE NO. 4063, 4067 DRAWING NO. 7713

[Signature]  
BRIDGE DESIGN ENGINEER